

Endoscopic Light Sheet Optics

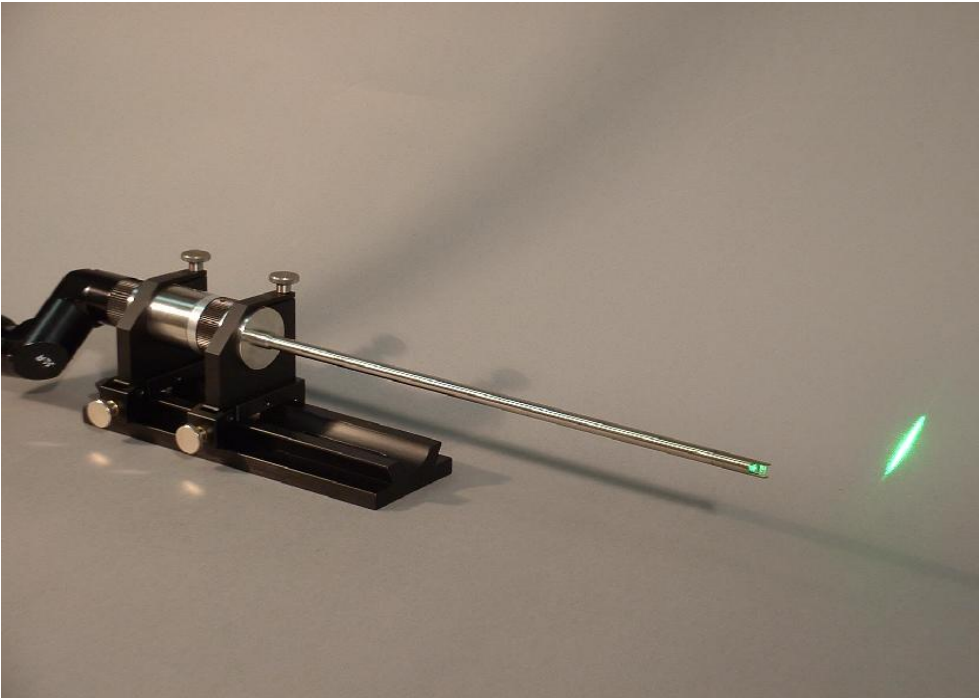

Endoscopic light sheet optics fitted with 90° prism

Are you running your PIV system in closed casings with difficult optical access? ILA provides you with different endoscopical light sheet optics with a diameter of 12 mm and rough lenses for Nd:YAG laser up to 220 mJ. The small diameter of 12 mm minimize the vitiation of the flow, although the small diameter ILA's endoscopic light sheet optics insure a thickness between 0.5....1 mm with fixed focal distance between 500...2000 mm and a divergence angle of 26°. The endoscopic light sheet optic can be mounted directly in front to the laser or on an small rail with an adapter to ILA's articulated mirror arm.

Alternatively the endoscopic light sheet optic can be delivered with a prism in front to make redirection angles up to 90° possible. Due to the prism the divergence angle is reduced to 16°.

Specifications

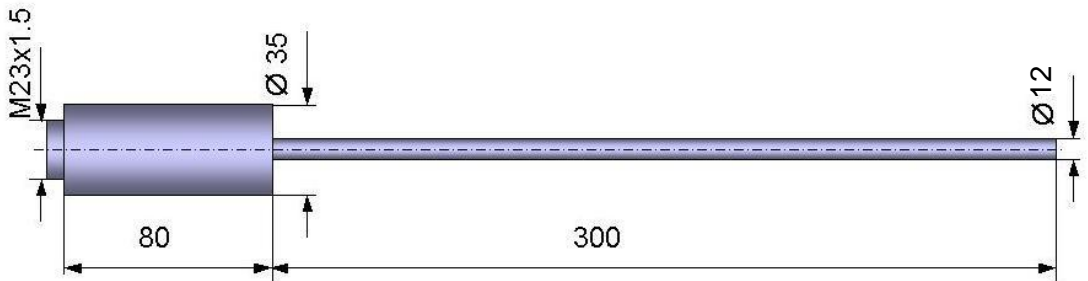

- Weight 418 g
- Light sheet divergence angle 26° @ 0° or 16° @ 90°
- Light sheet thickness 0.5...1 mm (depends on laser beam quality)
- Focal distance 500...2000 mm
- Dimensions 80 mm x Ø35 mm
- Tube diameter Ø12 mm
- Tube length 300 mm

Options

Alternatively the endoscopic light sheet optic can be delivered with a prism in front of the tube that enables fixed redirection angles: up to 90° (reduced divergence angle of 16°)



Endoscopic light sheet optics @ 0°

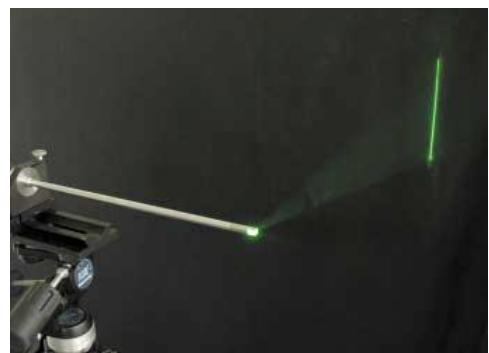

Endoscopic light sheet optics @ 90°

